

Layout Plan 1:100

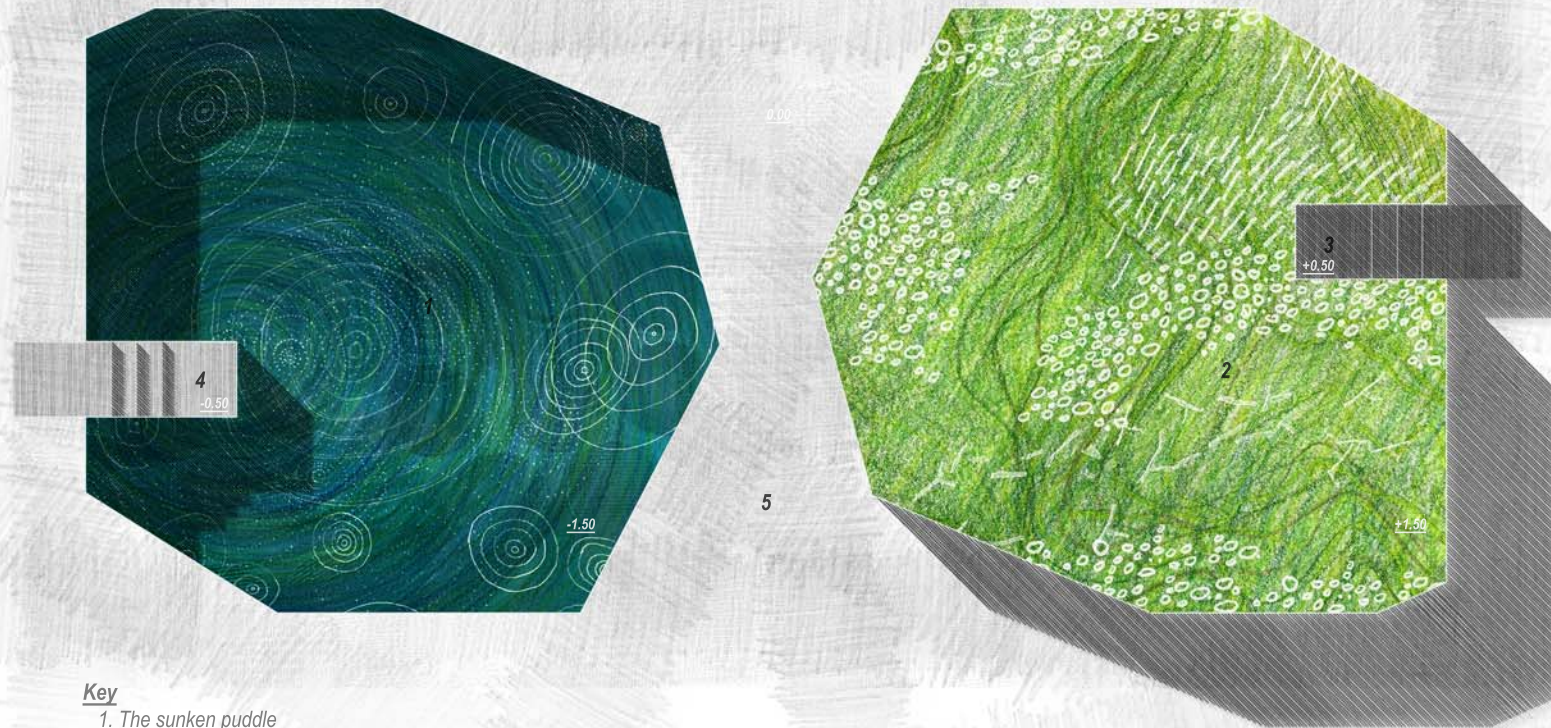

Key

1. The sunken puddle
2. The lifted prairie
3. The cut-out observatory
4. The deck observatory
5. The deambulatory walk
6. The exposed soil

Section-elevation 1:100

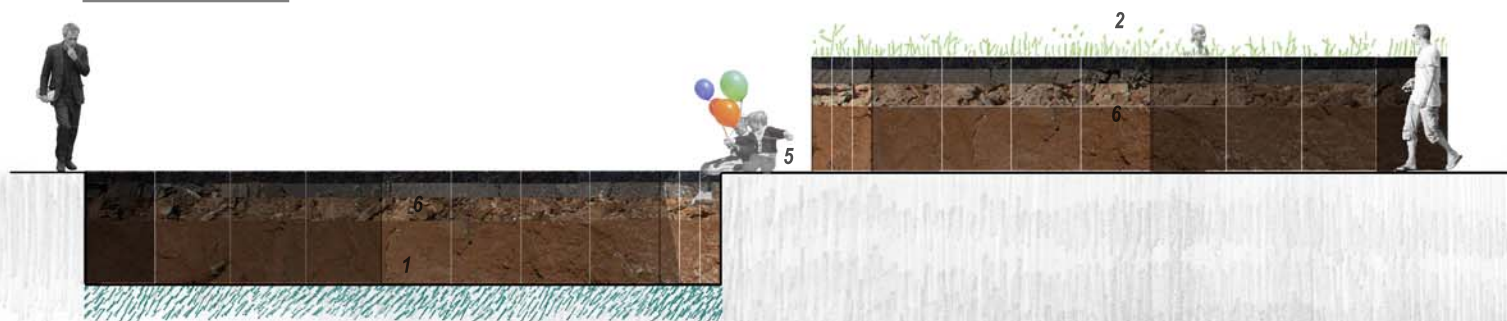

Section 1:100

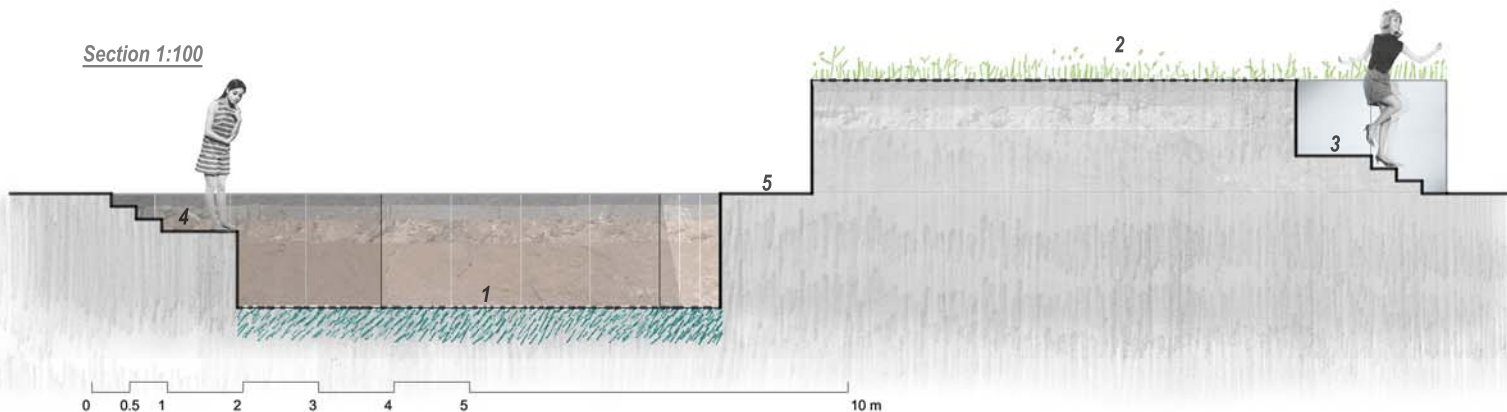

Description:

By carefully digging into the soil until reaching the water table at -1.5m, removing each of its layers in a surgical manner, piling these materials next to this void, and laying out the strata in the same order, the proposal shows that gardening is a transformation process in which equilibrium within a site plays a crucial role. The garden is made up of the matter of the place itself, from the water table to the sky, with the usually unseen technology of the soil's section and its components revealed and in full view, both downwards towards the deeper realms of the earth and upwards towards the life that takes place above ground. To achieve this, retention in the excavated part and contention of the pile is obtained by means of transparent reinforced security glass, through which visitors can experience the different behaviours of the soil's diverse materials, their change in time once they have been manipulated and exposed, as well as their influence on the resulting horizontal man-made landscapes and ecosystems: a shimmering puddle of water and a wild prairie.

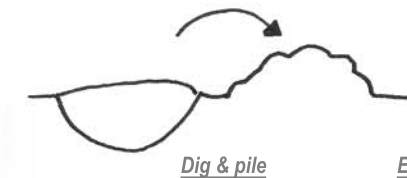

Dig & pile

Earth section: Topsoil-subsoil

- A. Organic layer
- B. Topsoil
- C. Improved subsoil
- D. Subsoil
- E. Water table

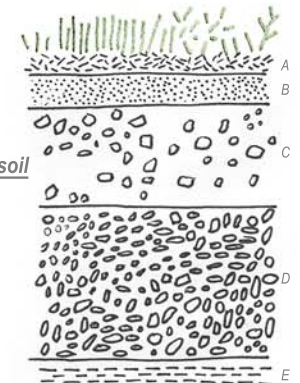

List of suggested plants:

Prairie

Mix of wildflower and native grasses to this area of Quebec.

Wildflowers: Lavender Hyssop, Common Milkweed, Canada Milk Vetch, Lance-leaf Coreopsis, Blanketflower, Ox-Eye Sunflower, Bergamot, Evening Primrose, White Aster, Mountain Mint, Black-Eyed Susan, Green-Headed Cone Flower, Branched Cone Flower, Smooth Aster, Hoary Vervain or similar ones.

Grasses: Canada Wild Rye, June Grass, Little Bluestem, Prairie Dropseed

Puddle

Oxygenators and small floating plants.

Frogbit, Marsh Pennywort, Starwort, or similar native species to shallow ponds of the area.

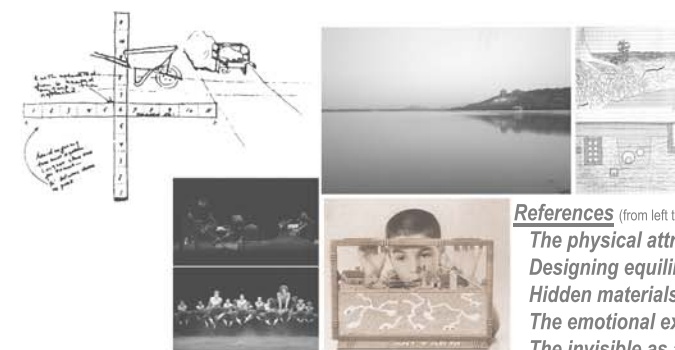

References (from left to right, and from top to bottom)

The physical attributes of earth (sketch of *Shifting Concern* by Cecile Abish)

Designing equilibrium (photo of Longevity Hill & Kunming Lake)

Hidden materials of gardening (Drawing of *Soil X-ray* by Teresa Galli)

The emotional expressionism of earth (photos of *La Sacre du Printemps* by Pina Bausch)

The invisible as a ludic, scientific and living observatory (photo of an *Ant Farm*)



View: model 1:100



View: artist impression